

## Spring Retractable Single Line Fuel Gas Welding Hose Reels



**Series SW** - 1/4", 3/8" I.D.

### Reel

- Hard coated, wear-resistant aluminum double-sealed full flow swivel
- Corrosion resistant baked-on powder coat

### Hose

- Ideal for welding service – meets ARPM IP-7 and CGA E-1 standards for T-grade
- Non-conductive
- **Tube:** Synthetic rubber compound compatible with all common welding fuel gases
- **Reinforcement:** Spiral synthetic yarn
- **Cover:** Red synthetic rubber with ribbed surface

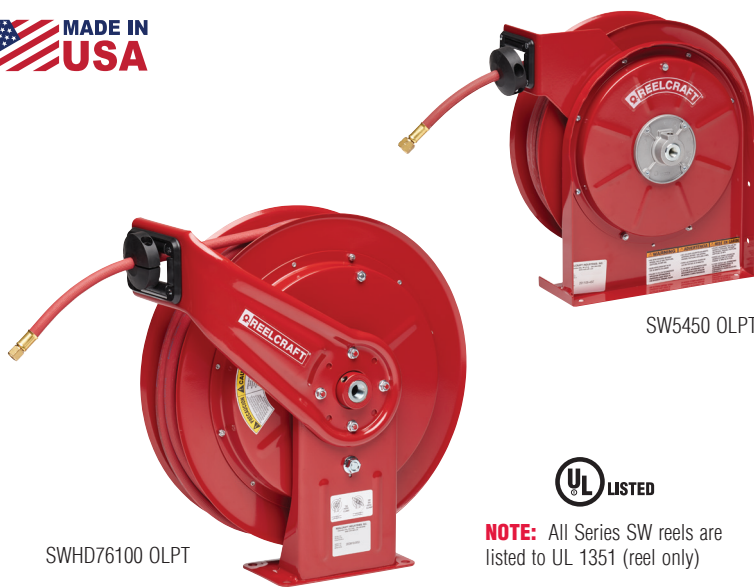

SWHD76100 OLPT

SW5450 OLPT



**NOTE:** All Series SW reels are listed to UL 1351 (reel only)



**Interactive Reel Catalog**

Visit [reelcraft.com/catalog](http://reelcraft.com/catalog) for complete product specifications, parts, and accessories.

**NEW!**

**Reel Covers**

See page 36



**Pivot Bases & Swing Brackets**  
See page 39



**Inlet & Outlet Hoses**  
See page 31

### Features

- Designed to improve safety in the work area with an increase in productivity and efficiency
- Full flow shaft swivels
- Double-sealed, O-rings prevent leakage
- Durable abrasion and corrosion resistant baked-on red powder-coated finish
- Reel frame, spool, and drum are fabricated of heavy gauge steel

Fuel gases commonly used in the welding, pre-heating, soldering, brazing, laboratory, heat gun, and cutting industries including, but not limited to, Acetylene, Hydrogen, Methane, Natural Gas, LP Gas, Mapp, and Propane

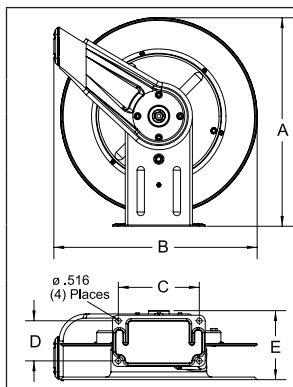

|          | Size Index                     |     |                                |     |                                |     |
|----------|--------------------------------|-----|--------------------------------|-----|--------------------------------|-----|
|          | 1                              |     | 2                              |     | 3                              |     |
|          | in                             | mm  | in                             | mm  | in                             | mm  |
| <b>A</b> | 14 <sup>3</sup> / <sub>8</sub> | 365 | 20 <sup>1</sup> / <sub>4</sub> | 514 | 20 <sup>1</sup> / <sub>4</sub> | 514 |
| <b>B</b> | 13 <sup>3</sup> / <sub>4</sub> | 349 | 19 <sup>3</sup> / <sub>4</sub> | 502 | 19 <sup>3</sup> / <sub>4</sub> | 502 |
| <b>C</b> | 9 <sup>3</sup> / <sub>4</sub>  | 248 | 7 <sup>7</sup> / <sub>8</sub>  | 200 | 7 <sup>7</sup> / <sub>8</sub>  | 200 |
| <b>D</b> | 2 <sup>1</sup> / <sub>2</sub>  | 64  | 3 <sup>7</sup> / <sub>8</sub>  | 98  | 3 <sup>7</sup> / <sub>8</sub>  | 98  |
| <b>E</b> | 6                              | 156 | 7                              | 178 | 8 <sup>1</sup> / <sub>4</sub>  | 210 |

| Model with hose & bumper   | Shipping Weight |    | Hose I.D. |    | Hose O.D. |    | Hose Length |    | Max Pressure |     | Hose Outlet B Size LH Thread | NPT(F) Reel Inlet | Reel Outlet | Size Index # |
|--|-----------------|----|-----------|----|-----------|----|-------------|----|--------------|-----|------------------------------|-------------------|-------------|--------------|
|  | lbs             | kg | in        | mm | in        | mm | ft          | m  | psi          | bar | in                           | in                | in          |              |
| <b>Single Line Fuel Gas Welding Reels</b> Maximum Temperature 150 °F (65 °C) |                 |    |           |    |           |    |             |    |              |     |                              |                   |             |              |
| SW5425 OLPT  | 26              | 12 | 1/4       | 6  | .530      | 13 | 25          | 8  | 200          | 14  | 9/16 - 18(F)                 | 1/4               | 9/16-18(M)  | 1            |
| SW5450 OLPT  | 28              | 13 | 1/4       | 6  | .530      | 13 | 50          | 15 | 200          | 14  | 9/16 - 18(F)                 | 1/4               | 9/16-18(M)  | 1            |
| SW7650 OLPT  | 43              | 20 | 3/8       | 10 | .660      | 17 | 50          | 15 | 200          | 14  | 9/16 - 18(F)                 | 1/2               | 9/16-18(M)  | 2            |
| SWHD76100 OLPT   | 75              | 34 | 3/8       | 10 | .660      | 17 | 100         | 30 | 200          | 14  | 9/16 - 18(F)                 | 1/2               | 9/16-18(M)  | 3            |